

ISTinox PCA units

The cool solution

POU 500E

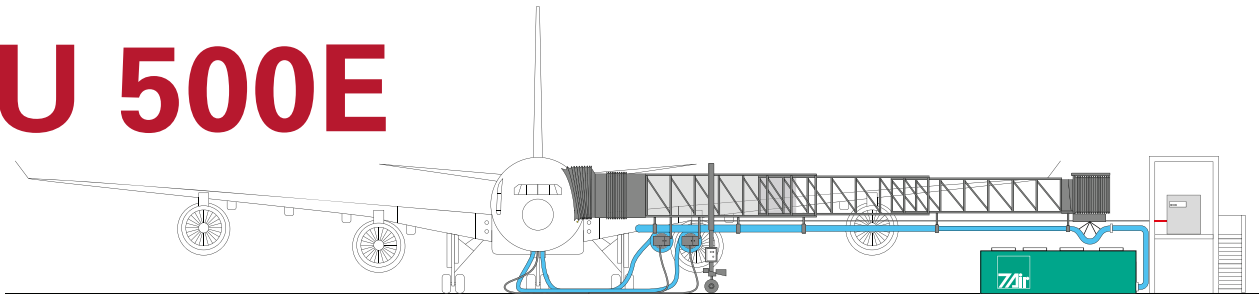

- Do you have difficulties to cool down the aircrafts at your airport?
- Are the aircrafts not pulled down fast enough?
- Is the cabin too warm when passengers are boarding?

We have the solution: ISTinox PCA brings comfort into each aircraft – under all conditions.

- ISTinox offers complete systems to supply aircrafts with PCA and 400Hz power
- The ISTinox PCA units are designed to meet the requirements of all aircraft types under all climatic conditions - guaranteed
- The ISTinox PCA units have a standard design and are built in modules. Therefore they can flexibly respond to the specific requirements of each airport

Key advantages of the ISTinox PCA units

- Environmentally sound technology through maximum energy efficiency and small refrigerant contents
- Designed for extreme longevity: all major components are made in stainless steel; motors, compressors and fans are high quality and high efficiency; casing with extruded aluminium profile frame and insulated double metal sheet panels
- Supply the aircraft continuously with cold air, i.e. the unit does not stop for deicing of the air cooling coils

Characteristics

- Air flow range from 5'300 kg/hr to 15'000 kg/h to cover aircraft codes C/D/E/F (except A380).
- Main components equipped with variable speed drives to minimise electric power consumption
- Temperature at the PCA unit outlet in cooling mode - 6°C
- Continuous cooling during operation
- Automatic control of the air supply system

Technical data sheet for POU 500E *

Aircraft Code	C/D/E/F (except A380)	
Cooling capacity	[kW]	500
Type of refrigerant	R 134a	
Weight of refrigerant	[kg]	ca. 220
Air handling component		
Max outside air temperature / relative humidity	[°C / %r.h.]	46 / 30
Supply air temperature (at PCA unit outlet)	[°C]	- 6
Static pressure at PCA unit outlet (@max air flow rate)	[Pa]	13'000
Unit air flow rate minimum / maximum	[kg/h]	5'300 / 15'000
Electrical power requirements		
Total power (nominal)	[kVA]	473
Operating current	[A]	683
Voltage / frequency	[V / Hz]	3x400/230 / 50
Dimensions / weights		
Length	[mm]	ca. 6'600
Width	[mm]	ca. 2'250
Height	[mm]	ca. 2'975
Weight	[kg]	ca. 10'400

* designed for climatic conditions of max 46°C/30% r.h.
For the A380 two units are required.

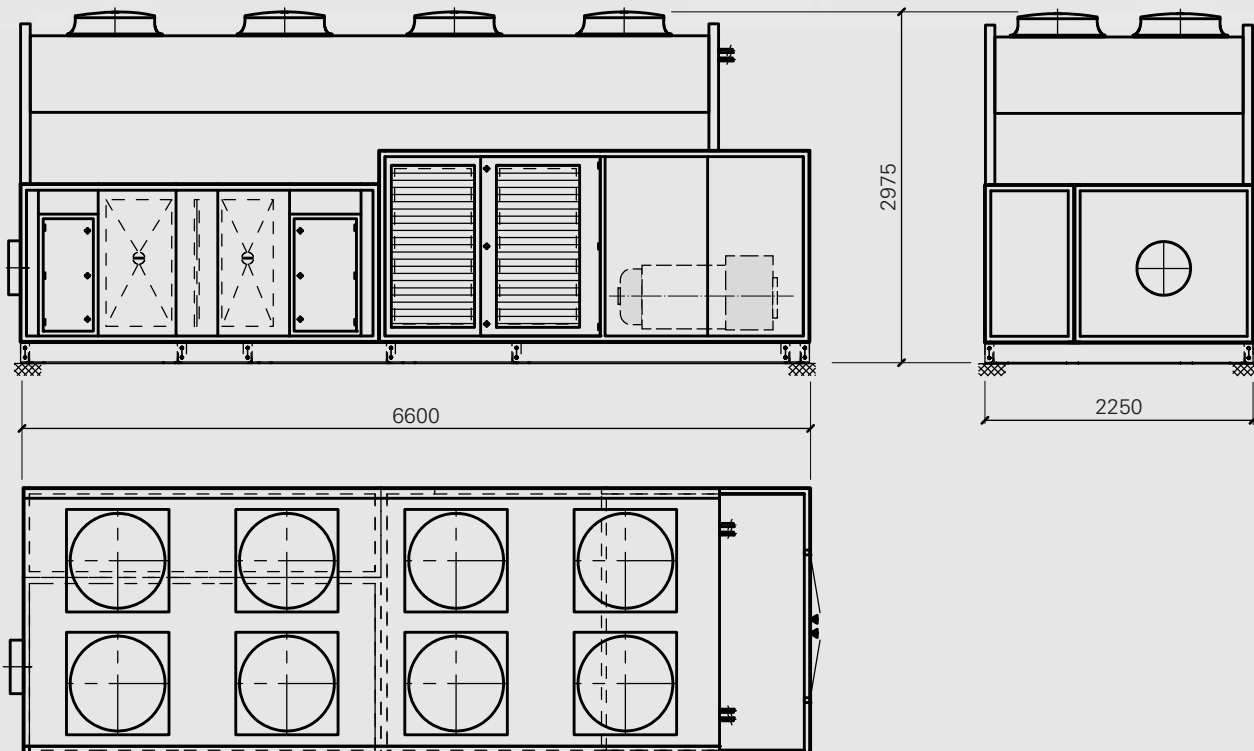

IST has more than 35 years of experience, component expertise, and innovative ideas, contact us:

Contact: IST-Edelstahl-Anlagenbau AG, Schorenstrasse 54, CH-3645 Thun-Gwatt, Switzerland, ist@istinox.ch, www.istinox.ch